

182
HEX5
MONOFACIAL

BSM560M10-72HPH 540~560W

BLUESUN SOLAR CO.,LTD

Bluesun, founded in 2004, as a superior photovoltaic manufacturer, is devoted to the R&D and the production of crystalline silicon solar cells and modules for 17 years. The company has its sales areas spread all over more than 100 countries and regions in the world, and the cumulative historical shipments exceeded 12 GW.

PERFORMANCE WARRANTY

- 12** Enhanced Product Warranty on Materials and Workmanship.
- 25** Linear Power Performance Warranty*
- 0.55%** Annual Degradation Over 25 years no more than 0.55%

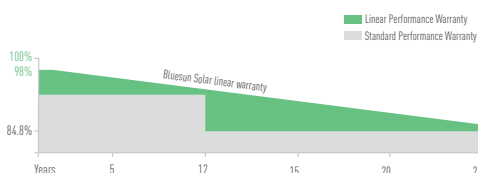

*According to the applicable Bluesun Solar Limited Warranty Statement.

MANAGEMENT SYSTEM CERTIFICATES

- ISO 9001:2015 / Quality management system
- ISO 14001:2015 / Standards for environmental
- ISO 45001: 2018 / International standards for occupational health & safety

PRODUCT CERTIFICATES

- IEC 61215 / IEC 61730 / TUV



THE IDEAL SOLUTION FOR:

-  Rooftop arrays on commercial industrial buildings
-  Ground-mounted solar power plants



High module conversion efficiency

MBB Half Cell Technology, Module efficiency up to 21.68%



Withstanding harsh environment

Reliable quality leads to a better sustainability even in harsh environment like desert, farm and coastline



PID Resistance

Excellent Anti-PID performance guarantee via optimized mass-production process and materials control



Excellent weak light performance

More power output in weak light condition, such as cloudy, morning and sunset



Extended wind and snow load tests

Module certified to withstand extreme wind (2400 Pa) and snow loads (5400 Pa)

SPECIFICATIONS

Module Type	BSM540M10-72HPH		BSM545M10-72HPH		BSM550M10-72HPH		BSM555M10-72HPH		BSM560M10-72HPH	
	STC	NMOT	STC	NMOT	STC	NMOT	STC	NMOT	STC	NMOT
Maximum Power (Pmax/W)	540	402	545	406	550	410	555	413	560	416
Operating Voltage (Vmp/V)	41.96	38.29	42.06	38.35	42.16	38.43	42.24	38.52	42.33	38.59
Operating Current (Imp/A)	12.87	10.50	12.96	10.58	13.05	10.66	13.14	10.73	13.23	10.80
Open-Circuit Voltage (Voc/V)	49.60	46.12	49.70	46.21	49.80	46.31	49.90	46.40	50.00	46.49
Short-Circuit Current (Isc/A)	13.74	11.10	13.84	11.18	13.94	11.27	14.04	11.34	14.14	11.42
Module Efficiency $\eta_m(\%)$	20.90		21.10		21.30		21.49		21.68	

STC: Irradiance 1000W/m², Cell Temperature 25°C, Air Mass AM1.5 NMOT: Irradiance at 800W/m², Ambient Temperatur 20°C, Air Mass AM1.5, Wind Speed 1m/s

I-V CURVE

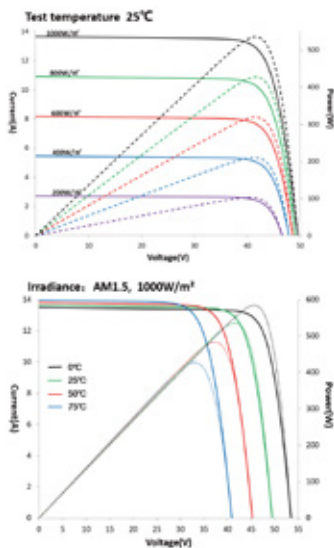

ENGINEERING DRAWINGS

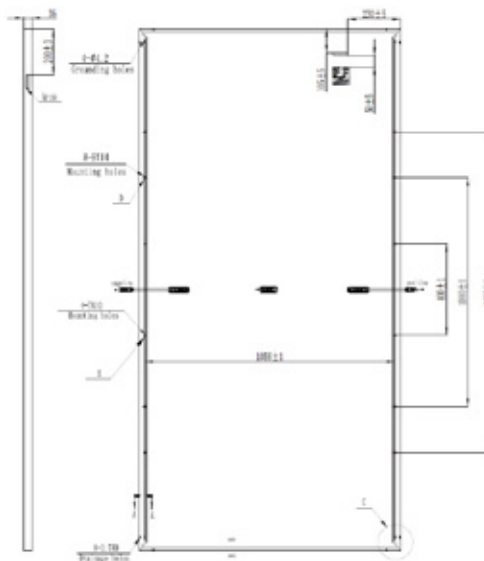

MECHANICAL SPECIFICATION

Cell Type	Monocrystalline
Cell Dimensions	182*91mm
Cell Arrangement	144 (6*24)
Weight	28.6kg
Module Dimensions	2278*1134*35mm
Cable Length	Portrait 300mm/Landscape 1200mm/Customized
Cable Cross Section Size	TUV: 4mm ² (0.006inches ²)/UL: 12AWG
Front Glass	3.2mm (0.13inches) AR Coating Tempered Glass
No. of Bypass Diodes	3
Packing Configuration	31pcs/carton, 620pcs/40hq
Frame	Anodized Aluminium Alloy
Junction Box	IP68

OPERATING CONDITIONS

Maximun System Voltage	1000/1500V/DC(IEC)
Operating Temperature	-40°C~ +85°C
Maximun Series Fuse	25A
Static Loading	Snow Loading: 5400Pa/ Wind Loading: 2400Pa
Conductivity at Ground	≤0.1Ω
Safety Class	II
Resistance	≥100MΩ
Connector	T01/LJQ-3-CSY/MC4/MC4-EVO2

TEMPERATURE COEFFICIENT

Temperature Coefficient Pmax	-0.36%/°C
Temperature Coefficient Voc	-0.29%/°C
Temperature Coefficient Isc	+0.048%/°C
NMOT	45±2°C

*Data contained in these specifications is subject to change without notice. Bluesun Solar reserves the right to final interpretation of content.